

# THR/THD Pins



## Features and Benefits

- Accu-Post™ terminals feature a unique mounting design that improves PCB quality and reduces instances of solder joint fractures, and loose or misaligned posts.
- This Accu-Lok™ mounting assures superior retentive strength, perpendicularity and solder joint integrity.
- Retention is accomplished by a controlled splitting and forming of the terminal leg.
- Accu-Lok™ mounting permits the use of mounting holes with a diameter tolerance of  $\pm 0.003$ " ( $\pm 0.076$ mm).
- Forces due to mating, withdrawal, vibration, shock, or temperature cycles are not transferred to the PCB solder joint.
- Since the unique design of Accu-Lok™ is not a press fit, hole damage and deformity do not occur.



PCB retention of Accu-Lok™ is accomplished by a controlled splitting and forming of the terminal leg during insertion.

The solder joint is protected from stresses due to mating, withdrawal, or shock.

The retentive mounting feature of Zierick's Accu-Lok™ produces exceptional PCB assembly and interconnection integrity.

Since the unique design of Accu-Lok™ is not a press fit, hole damage and deformity do not occur.

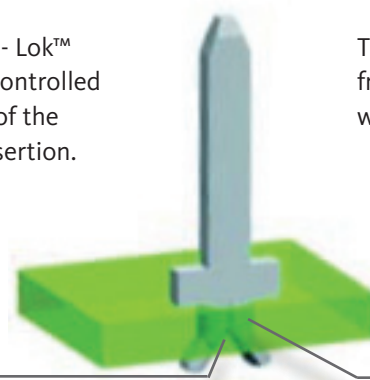
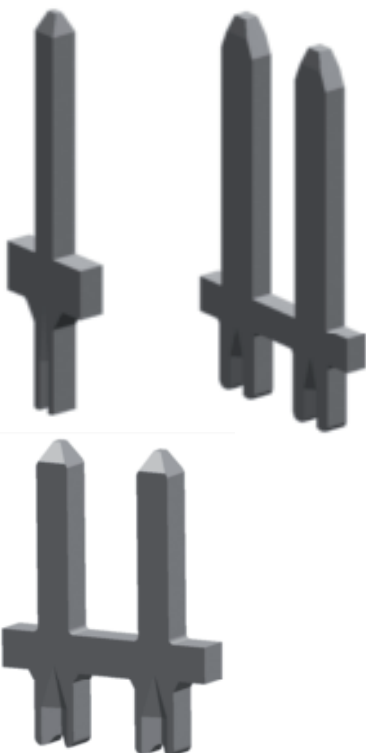

## 0.031" x 0.062" (0.79mm x 1.57mm)

### Part Number 6073-xxx

Loose Part No.	6073-300	6073-400	6073-490	6073-615	6073-xxx-xxx
Dimension 'A'	0.350" (8.89mm)	0.400" (10.16mm)	0.490" (12.45mm)	0.615" (15.62mm)	Customer Req.
Mounting Type	Split Leg Splay				
Material Thickness / Type	0.032" (0.81mm) Brass				
Standard Finish	100% Tin over Copper				
Mounting Hole Diameter	0.078" (1.98mm)				
Current Rating	10 Amperes				
Applicator System	Model 9700, 9700 XY				

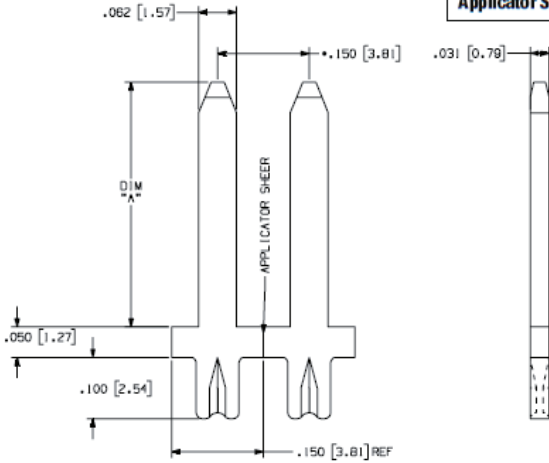

Typical Accu-Lok™ Mounting

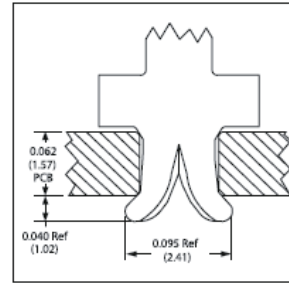

Typical PCB Grid Geometry

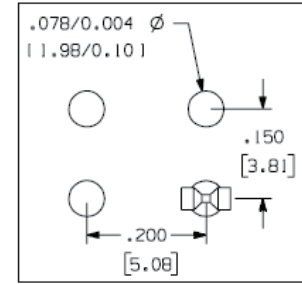

## 0.045" (1.14mm) Square

### Part Number 6075-xxx

Loose Part No.	6075-250	6075-312	6075-450	6075-500	6075-575	6075-650	6075-750	6075-930
Dimension 'A'	0.250" (6.35 mm)	0.312" (7.92 mm)	0.450" (11.43 mm)	0.500" (12.70 mm)	0.575" (14.61 mm)	0.650" (16.51 mm)	0.750" (19.05 mm)	0.930" (23.62 mm)
Mounting Type	Split Leg Splay							
Material Thickness / Type	0.045" (1.14mm) Brass							
Standard Finish	100% Tin over Copper							
Mounting Hole Diameter	0.072" (1.83mm)							
Current Rating	10 Amperes							
Applicator System	Model 9700, 9700 XY							

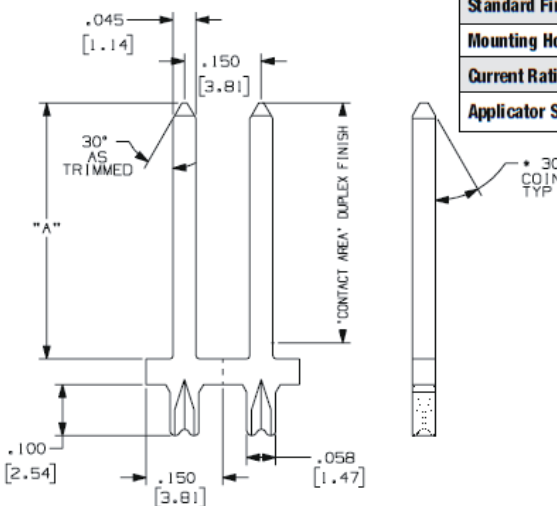

Typical Accu-Lok™ Mounting

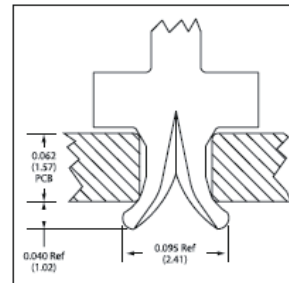

Typical PCB Grid Geometry

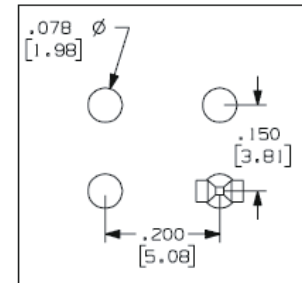

Werner Wirth GmbH

Hellgrundweg 111  
22525 Hamburg  
Germany

Tel +49 (0)40 752 491-0  
Fax +49 (0)40 752 491-91

info@wernerwirth.de  
www.wernerwirth.de



WERNER  
WIRTH

PROJECT | CONNECT | PROTECT

# 0.025" (0.64mm) Square

## Part Number 6143-xxx

<b>Loose Part No.</b>	6143-250	6143-xxx
<b>Dimension 'A'</b>	0.250"	Customer Reqmt.
<b>Mounting Type</b>	Split Leg Splay	
<b>Material Thickness / Type</b>	0.025" (0.64mm) C26000 Brass	
<b>Standard Finish</b>	100% Tin over Copper	
<b>Mounting Hole Diameter</b>	0.030"/0.043" (0.76mm/1.09mm)	
<b>Current Rating</b>	8 Amperes	

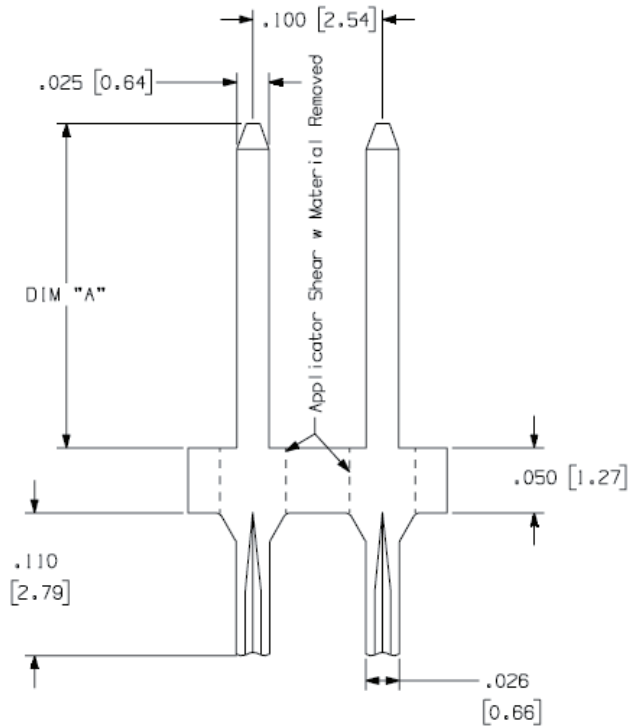

### Typical Accu-Lok™ Mounting

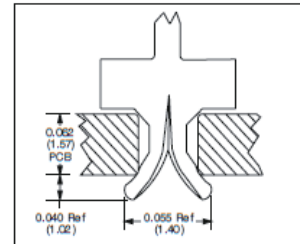

### Typical PCB Grid Geometry

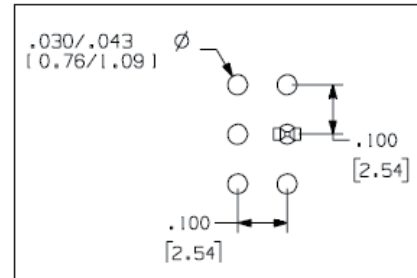

Werner Wirth GmbH

Hellgrundweg 111  
22525 Hamburg  
Germany

Tel +49 (0)40 752 491-0  
Fax +49 (0)40 752 491-91

info@wernerwirth.de  
www.wernerwirth.de



PROJECT | CONNECT | PROTECT